

INSTALLATION

1. INSTALL FRONT BUMPER REINFORCEMENT

- (a) Install the reinforcement with the 6 nuts.

Torque: 55 N*m (560 kgf*cm, 41 ft.*lbf)

FRONT BUMPER

COMPONENTS

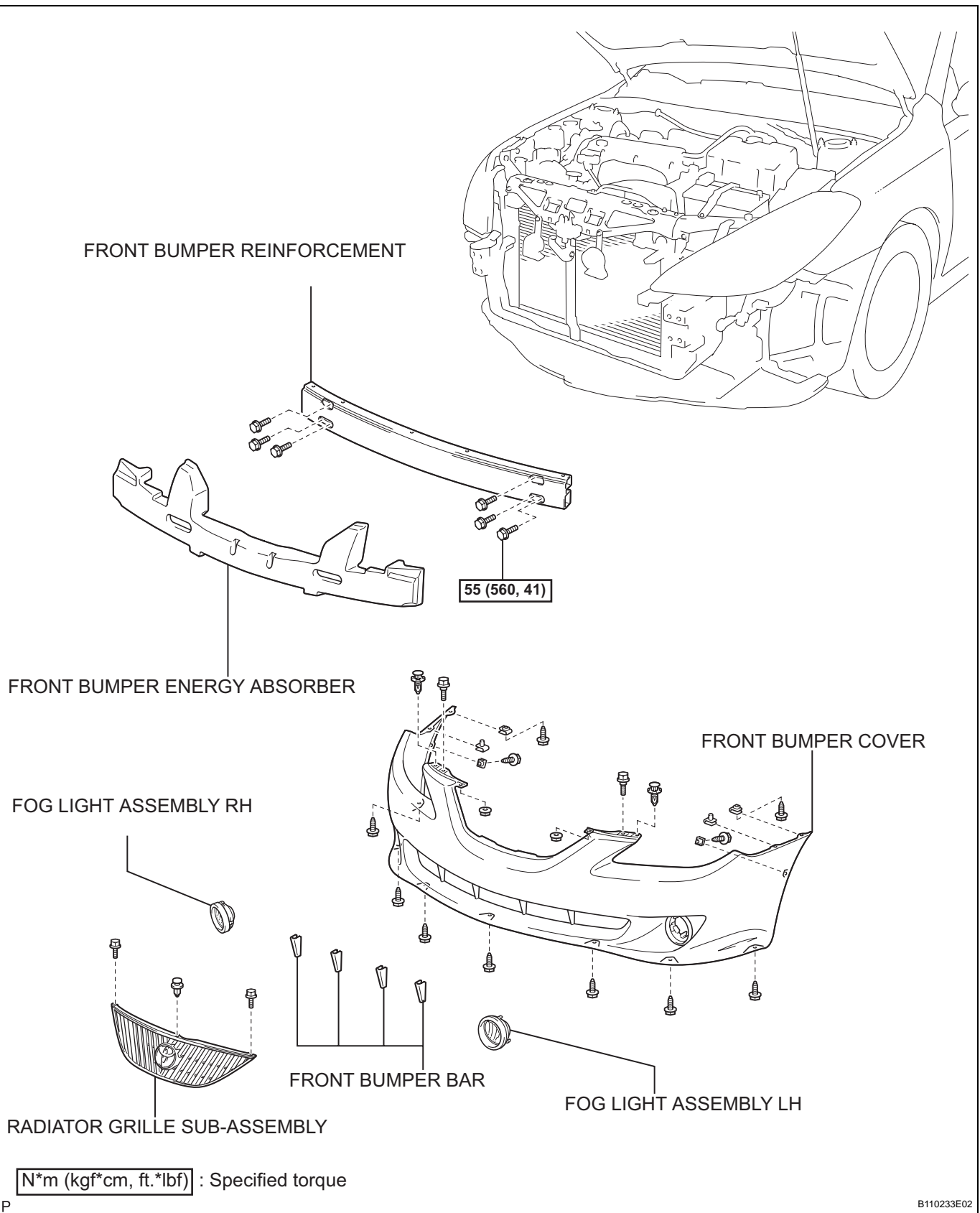

REMOVAL

HINT:

- The installation procedures are the removal procedures in reverse order. However, only installation procedures requiring additional information are included.
- A bolt without a torque specification is shown in the standard bolt chart (See page [SS-2](#)).

1. REMOVE RADIATOR GRILLE SUB-ASSEMBLY

- Remove the 2 bolts and clip.
- Using a screwdriver, disengage the 3 claws and remove the radiator grille.

HINT:

Tape the screwdriver tip before use.

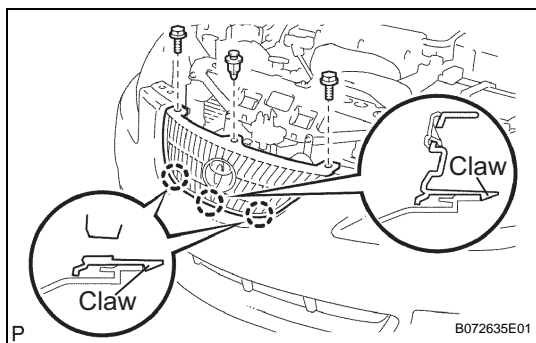

2. REMOVE FRONT FENDER LINER LH

- Remove the 2 screws.
- Partially remove the fender liner.

HINT:

It is not necessary to remove the fender liner completely but remove it partially so that the bumper cover can be removed in later step.

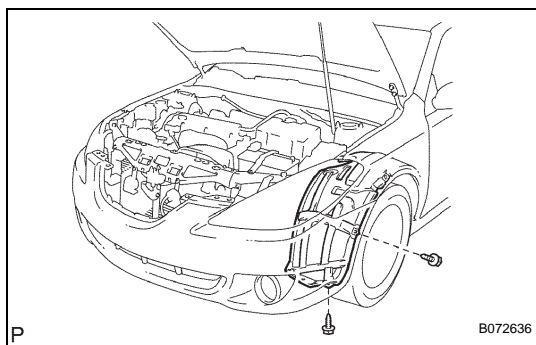

3. REMOVE FRONT FENDER LINER RH

HINT:

Use the same procedures described for the LH side.

4. REMOVE FRONT BUMPER COVER

- Put protective tape under the front fender.
- Remove the 7 screws, 2 bolts and 2 clips.
- Using a screwdriver, disengage the 4 claws and remove the bumper cover.

HINT:

Tape the screwdriver tip before use.

- Disconnect the 2 fog light connectors.

5. REMOVE FRONT BUMPER BAR

- Using a screwdriver, disengage the 16 claws and remove the 4 bumper bars.

HINT:

Tape the screwdriver tip before use.

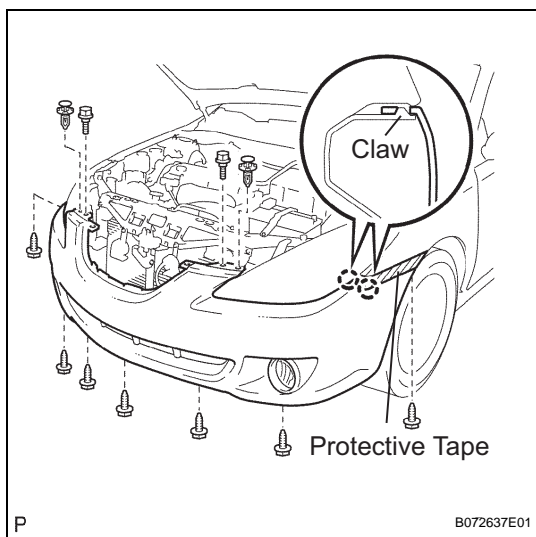

6. REMOVE FOG LIGHT ASSEMBLY LH

- Remove the 6 bolts and reinforcement.

7. REMOVE FOG LIGHT ASSEMBLY RH

8. REMOVE FRONT BUMPER ENERGY ABSORBER

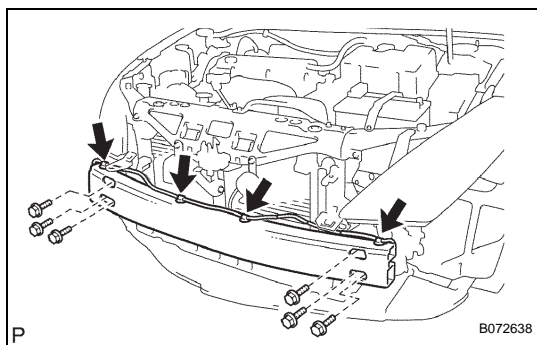
**9. REMOVE FRONT BUMPER REINFORCEMENT**

- (a) Using a screwdriver, disconnect the 4 wire harness clamps.

HINT:

Tape the screwdriver tip before use.

INSTALLATION

1. INSTALL REAR BUMPER REINFORCEMENT SUB-ASSEMBLY

- (a) Install the reinforcement with the 6 nuts.

Torque: 55 N*m (560 kgf*cm, 41 ft.*lbf)

REAR BUMPER

COMPONENTS

ET

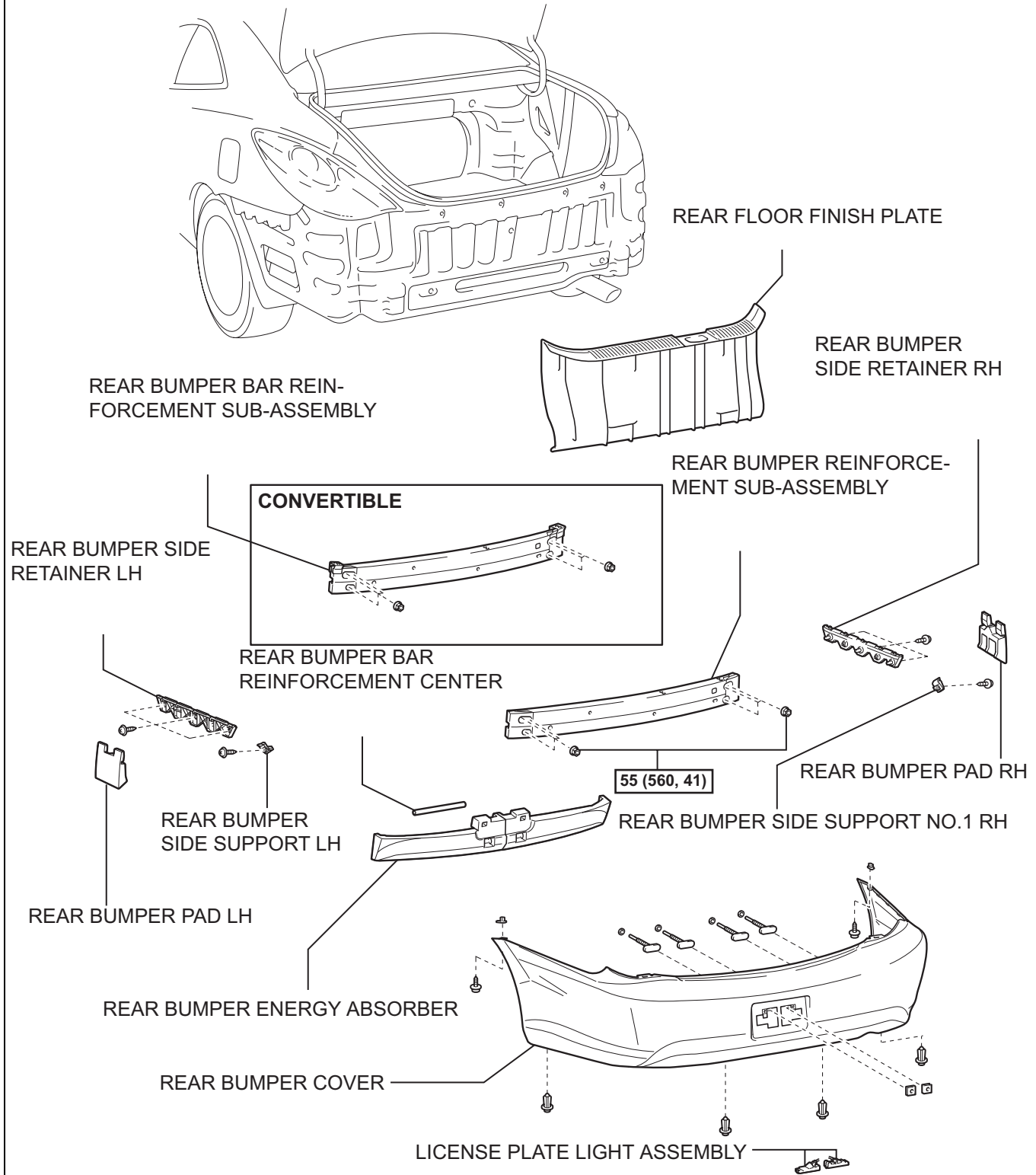

$\boxed{\text{N}^*\text{m (kgf}^*\text{cm, ft.}^*\text{lbf)}}$: Specified torque

P

B110234E02

REMOVAL

HINT:

- The installation procedures are the removal procedures in reverse order. However, only installation procedures requiring additional information are included.
- A bolt without a torque specification is shown in the standard bolt chart (See page [SS-2](#)).

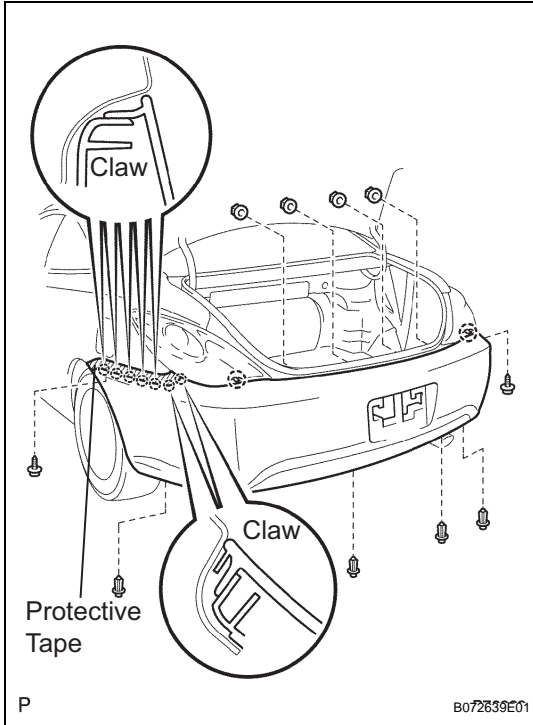

1. REMOVE REAR FLOOR FINISH PLATE

2. REMOVE REAR BUMPER COVER

- Put protective tape under the quarter panel.
- Remove the 4 clips, 2 screws and 4 nuts.
- Using a screwdriver, disengage the 7 claws and remove the rear bumper.

HINT:

- Tape the screwdriver tip before use.
- Disconnect the 2 license plate connectors.

3. REMOVE LICENSE PLATE LIGHT ASSEMBLY

4. REMOVE REAR BUMPER ENERGY ABSORBER

5. REMOVE REAR BUMPER BAR REINFORCEMENT CENTER

6. REMOVE REAR BUMPER REINFORCEMENT SUB-ASSEMBLY

- Remove the 6 nuts and reinforcement.

7. REMOVE REAR BUMPER PAD LH

8. REMOVE REAR BUMPER PAD RH

9. REMOVE REAR BUMPER SIDE RETAINER LH

- Remove the 3 screws and retainer.

10. REMOVE REAR BUMPER SIDE RETAINER RH

- Remove the 3 screws and retainer.

11. REMOVE REAR BUMPER SIDE SUPPORT LH

- Remove the screw and side support.

12. REMOVE REAR BUMPER SIDE SUPPORT NO.1 RH

- Remove the screw and side support.

NAME PLATE
COMPONENTS

ET

TOYOTA MARK

GRADE MARK

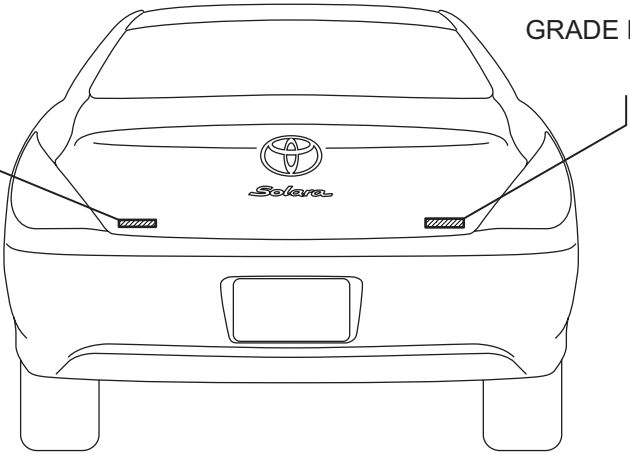

TOYOTA MARK

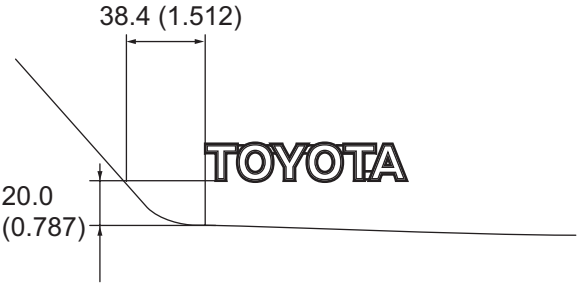

GRADE MARK

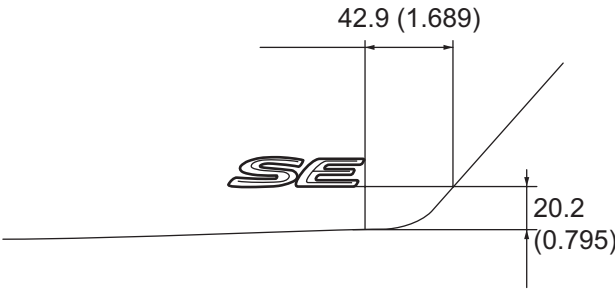
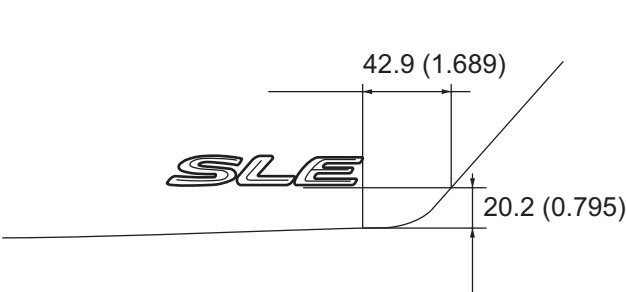
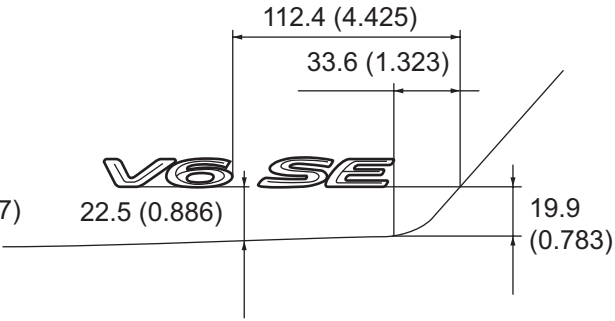
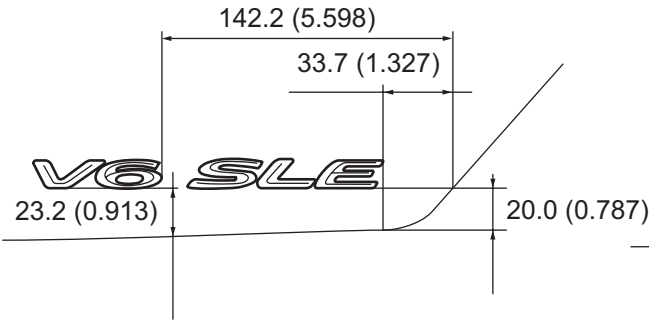

REAR SPOILER

REMOVAL

SS-2

HINT:

- The installation procedures are the removal procedures in reverse order. However, only installation procedures requiring additional information are included.
- When relacing the spoiler, heat the body and spoiler using a heat light.

Heating temperature

Item	Temperature
Body	40 to 60°C (104 to 140°F)
Spoiler	20 to 30°C (68 to 86°F)

ET

- A bolt without a torque specification is shown in the standard bolt chert (See page).
1. REMOVE LUGGAGE COMPONENT DOOR INSIDE HANDLE COVER (See page [ED-29](#))
 2. REMOVE LUGGAGE COMPARTMENT DOOR HANDLE INSIDE (See page [ED-29](#))
 3. REMOVE LUGGAGE COMPARTMENT DOOR COVER (See page [ED-29](#))
 4. REMOVE REAR SPOILER SUB-ASSEMBLY
 - (a) Remove the 4 bolts.
 - (b) Put protective tape onto the body.
 - (c) Heat the spoiler.

NOTICE:
Do not heat the spoiler excessively.

 - (d) Tie objects that can serve as handle (for example, wooden blocks) to all wire ends.
 - (1) Scrape the adhesive tape off by pulling the piano wire as shown in the illustration.
If planing to reuse the spoiler, take care not to damage the spoiler.

NOTICE:
Do not damage the body.
 - (e) Remove the spoiler.

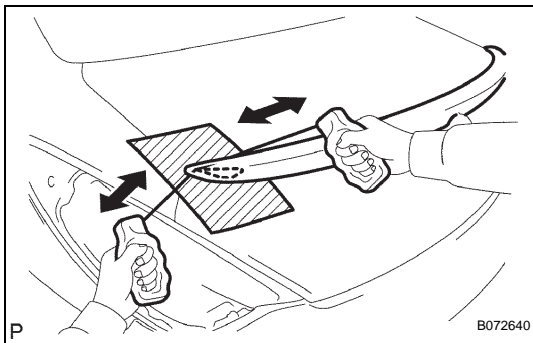

INSTALLATION

1. INSTALL REAR SPOILER SUB-ASSEMBLY

- (a) Heat the body mounting surface.

NOTICE:

Do not heat the spoiler excessively.

- (b) Remove the protective tape from the body.
(c) Wipe off the stains with cleaner.
(d) Clean the spoiler if planning to reuse it.

NOTICE:

Do not heat the body mounting surface excessively.

- (1) Remove the adhesive tape from the spoiler.

- (2) Wipe off the stains with cleaner.

- (e) Put new adhesive tape to the spoiler as shown in the illustration.

- (1) Heat the body and spoiler.

NOTICE:

Do not heat the spoiler and body excessively.

- (f) Install the spoiler with the 4 bolts.

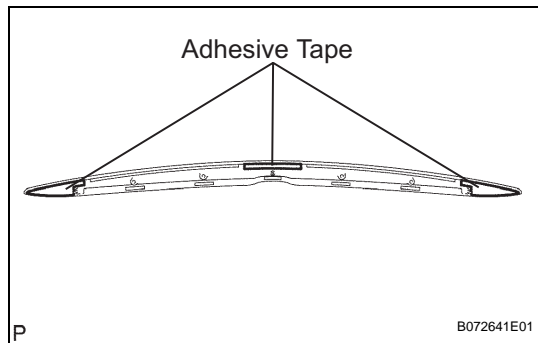
ET

FRONT DOOR BELT MOULDING

REMOVAL

HINT:

- The installation procedures are the removal procedures in reverse order.
- Use the same procedures for the RH side and LH side.
- The procedures listed below are for the LH side.

1. **REMOVE FRONT DOOR LOWER FRAME BRACKET GARNISH LH** (See page [ED-10](#))
2. **REMOVE FRONT DOOR INSIDE HANDLE BEZEL PLUG LH** (See page [ED-10](#))
3. **REMOVE FRONT DOOR TRIM BOARD SUB-ASSEMBLY LH** (See page [ED-11](#))
4. **REMOVE OUTER REAR VIEW MIRROR ASSEMBLY LH** (See page [MI-11](#))
5. **REMOVE FRONT DOOR WEATHERSTRIP LH**
 - (a) Using a clip remover, remove the 3 clips and front door weatherstrip.

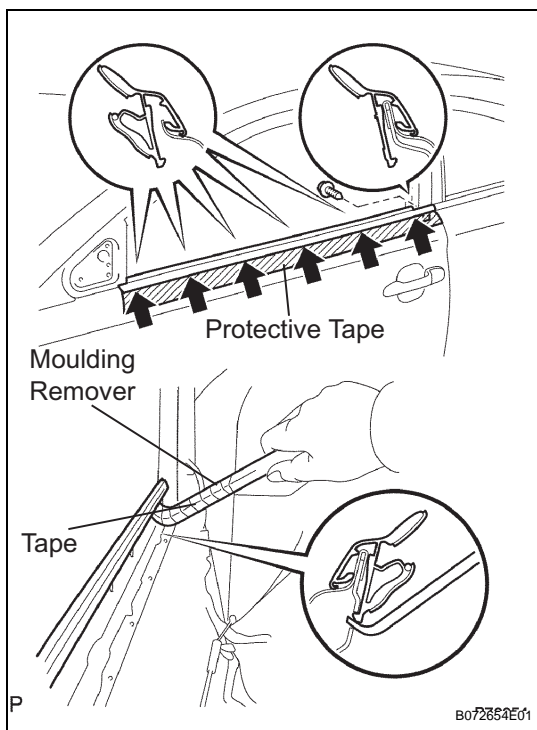
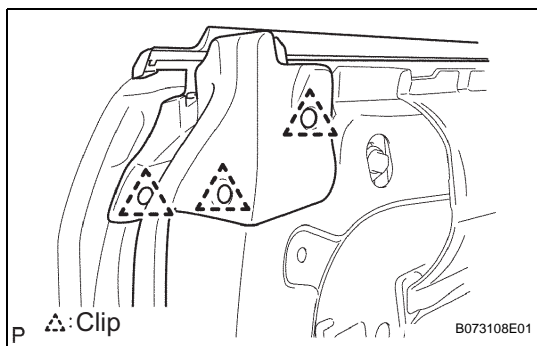

6. **REMOVE FRONT DOOR BELT MOULDING ASSEMBLY LH**

- (a) Put protective tape under the moulding.
- (b) Remove the screw.
- (c) Using a moulding remover, pry out the moulding as shown in the illustration.

HINT:

Tape the remover tip before use.

INSTALLATION

HINT:

- Use the same procedures for the RH side and LH side.
- The procedures listed below are for the LH side.

1. **INSTALL FRONT DOOR BELT MOULDING ASSEMBLY LH**
2. **INSTALL FRONT DOOR WEATHERSTRIP LH**
3. **INSTALL OUTER REAR VIEW MIRROR ASSEMBLY LH**
4. **INSTALL FRONT DOOR TRIM BOARD SUB-ASSEMBLY LH**
5. **INSTALL FRONT DOOR INSIDE HANDLE BEZEL PLUG LH**
6. **INSTALL FRONT DOOR LOWER FRAME BRACKET GARNISH LH**

QUARTER BELT MOULDING (for Convertible)

COMPONENTS

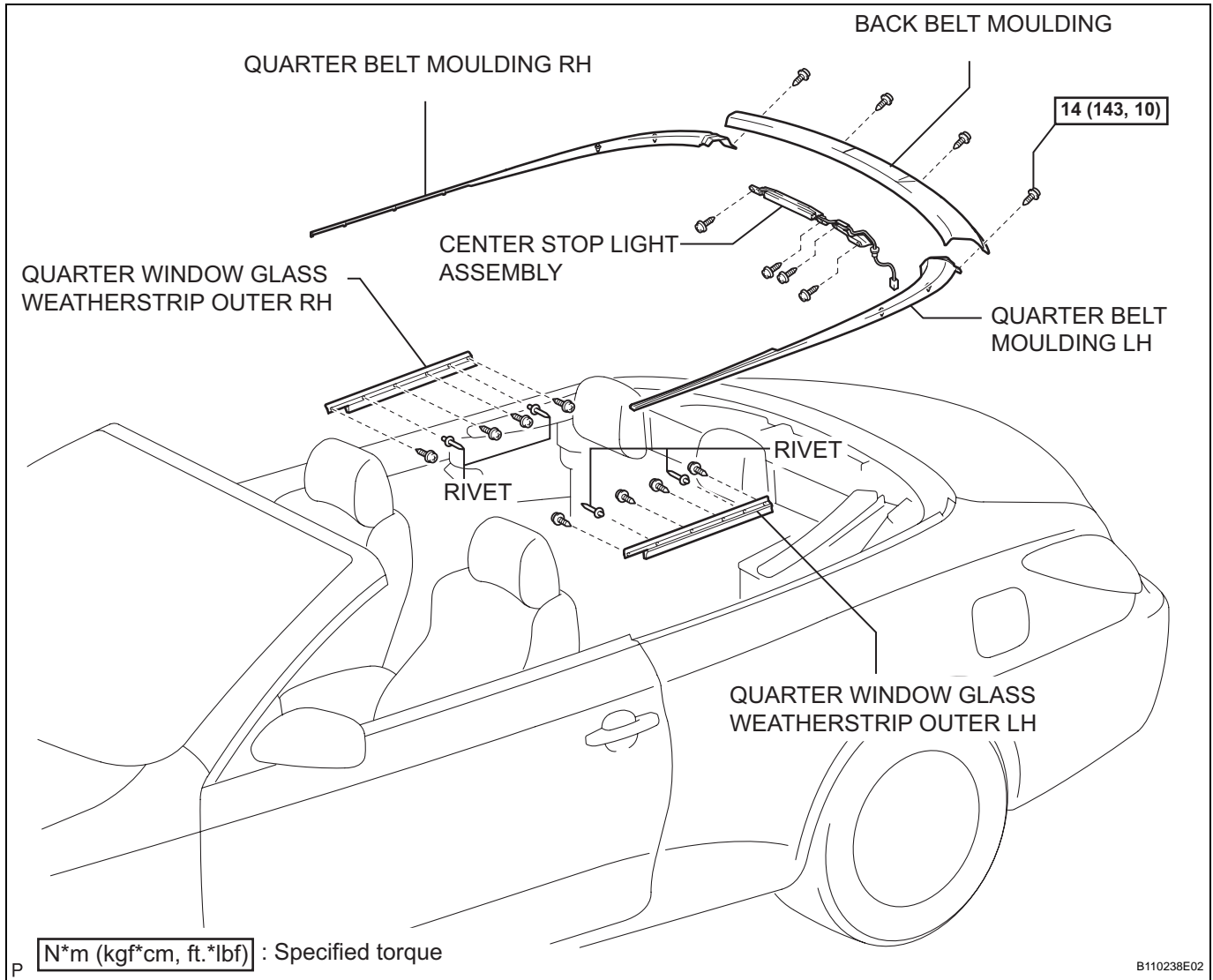

REMOVAL

HINT:

The installation procedures are the removal procedures in reverse order. However, only installation procedures requiring additional information are included.

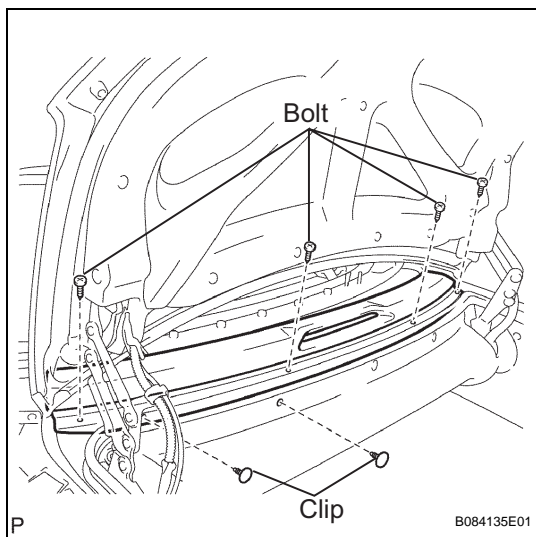

1. REMOVE BACK BELT MOULDING

- Remove the 4 bolts.
- Remove the 2 clips from the luggage trim front.
- Lift up the trim and disconnect the stop light connector.
- Pull up the rear part of the back belt moulding and push it forward to remove it.

2. REMOVE CENTER STOP LIGHT ASSEMBLY

- Remove the 4 screws and stop light from the back belt moulding.

3. REMOVE REAR SEAT ASSEMBLY

HINT:

See page [SE-46](#)

4. REMOVE FRONT SEAT OUTER BELT ASSEMBLY LH

HINT:

See page [SB-18](#)

5. REMOVE FRONT SEAT OUTER BELT ASSEMBLY RH

HINT:

See page [SB-21](#)

6. REMOVE CUP HOLDER NO.1

7. REMOVE CUP HOLDER NO.2

8. REMOVE QUARTER TRIM PANEL SUB-ASSEMBLY UPPER LH

HINT:

See page [IR-10](#)

9. REMOVE QUARTER TRIM PANEL SUB-ASSEMBLY UPPER RH

HINT:

See page [IR-10](#)

10. REMOVE QUARTER WINDOW ASSEMBLY LH

HINT:

See page [WS-122](#)

11. REMOVE QUARTER WINDOW ASSEMBLY RH

HINT:

See page [WS-122](#)

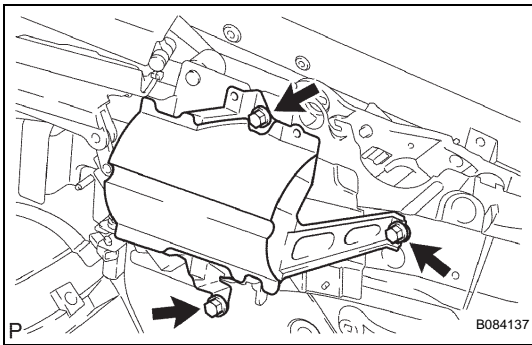

12. REMOVE QUARTER PANEL EXTENSION REINFORCEMENT LH

- (a) Remove the 3 bolts and reinforcement.

13. REMOVE QUARTER PANEL EXTENSION REINFORCEMENT RH

HINT:

Use the same procedures described for the LH side.

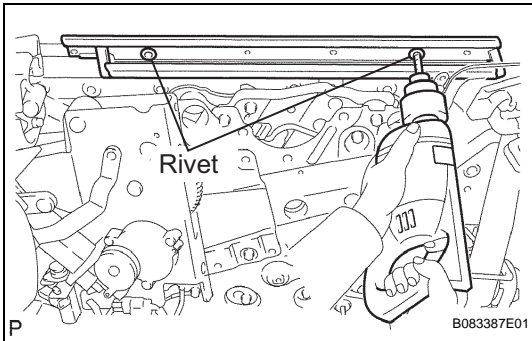

14. REMOVE QUARTER BELT MOULDING LH

- (a) Using a drill of less than ϕ 4 mm (0.16 in.), gently and perpendicularly place the drill tip onto the rivet and cut the rivet flanges.

HINT:

Wind tape around the drill bit approximately 5 mm (0.20 in.) from the tip of the drill, as shown in the illustration.

NOTICE:

- Be sure to gently place the drill perpendicular to the rivet, otherwise the rivet hole and the drill itself will be damaged.
- Be careful when performing this task, as the cut rivet is hot.
- Do not prize the riveter. The riveter will be damaged and the mandrel will bend.

- (b) Remove the moulding with the 3 clips.

15. REMOVE QUARTER BELT MOULDING RH

HINT:

Use the same procedures described for the LH side.

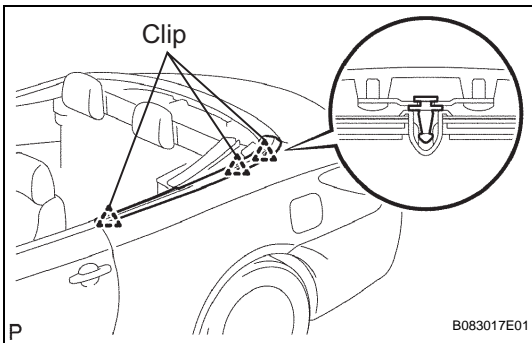

16. REMOVE QUARTER WINDOW GLASS WEATHERSTRIP OUTER LH

- (a) Remove the 4 screws and clip, weatherstrip from the quarter belt moulding.

17. REMOVE QUARTER WINDOW GLASS WEATHERSTRIP OUTER RH

HINT:

Use the same procedures described for the LH side.

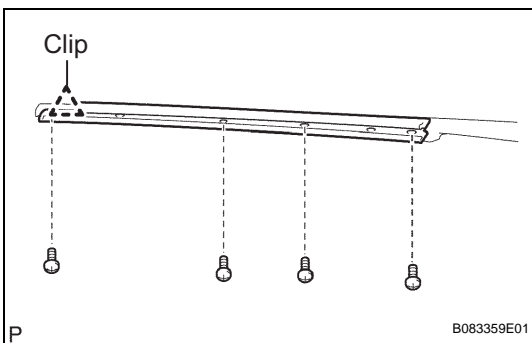

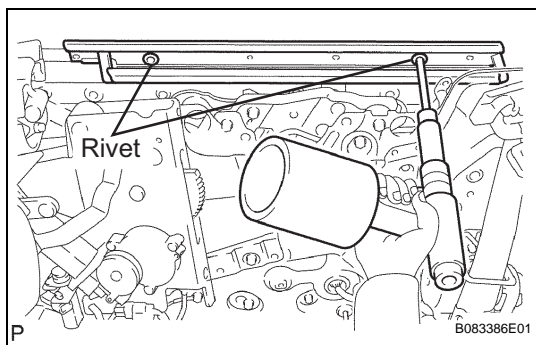

INSTALLATION

1. INSTALL QUARTER BELT MOULDING LH

- Using an air riveter or hand riveter, install the moulding.
- Installation of rivets.

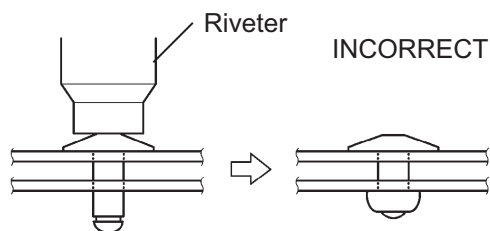

INCORRECT

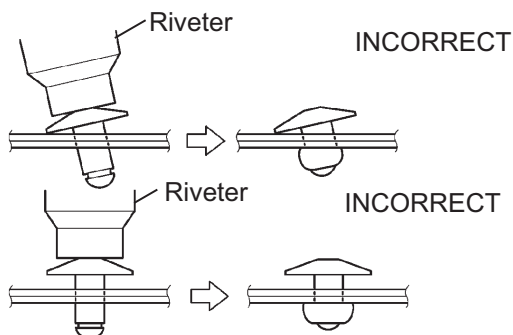
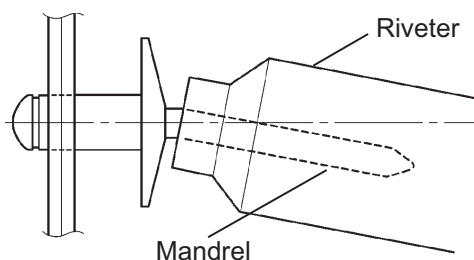

B113865E02

NOTICE:

- Do not prize the riveter. The riveter will be damaged and the mandrel will bend.
- Do not tilt the riveter when fastening the rivet to the bracket as this will cause the rivet to be loose.
- Do not have any space between the rivet head and the bracket. The rivet head must be completely flat against the bracket.
- Do not have any space between the bracket and curtain rail. Firmly hold together the 2 items while installing the rivet.

2. INSTALL QUARTER BELT MOULDING RH

HINT:

Use the same procedures described for the LH side.

INSTALLATION

1. INSTALL ROOF DRIP SIDE FINISH MOULDING CLIP NO.1

HINT:

Follow steps (a) to (c) only when replacing the clips.

- Remove the tape that remains on the mounting surface of the body, and then clean the surface with white gasoline.
- Heat the clip installation surfaces of the body and moulding.

NOTICE:

Do not heat the body and moulding excessively.

- Install new clips in the positions shown in the illustration. Press-fit the clips by hand.

NOTICE:

After press-fitting the clips, wait for 30 minutes or more before installing the moulding.

HINT:

- Minimum hardening time: 30 minutes
- Time needed for complete hardening: 24 hours

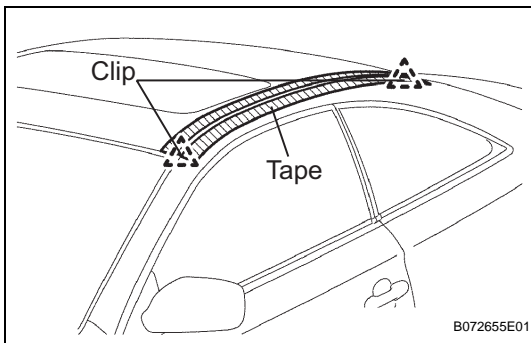
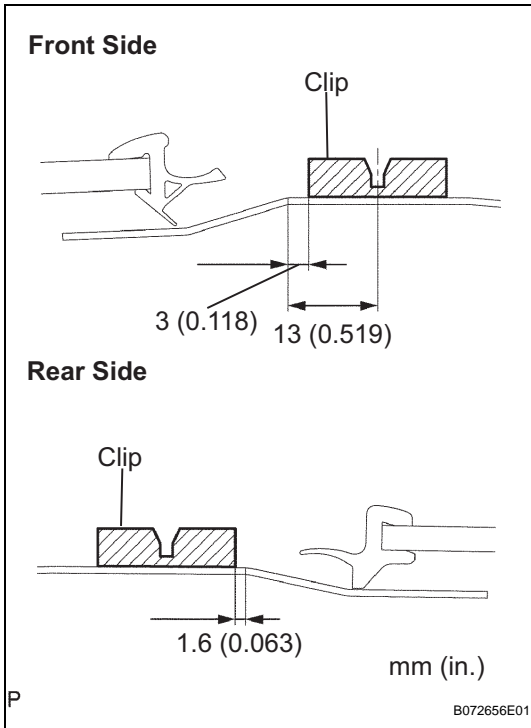

2. INSTALL ROOF DRIP SIDE FINISH MOULDING CENTER LH

- Adjust the position of the moulding so that the front and rear ends attach to the vehicle's 2 clips, and install the moulding.
- Remove the protective tape from the edge of the moulding.

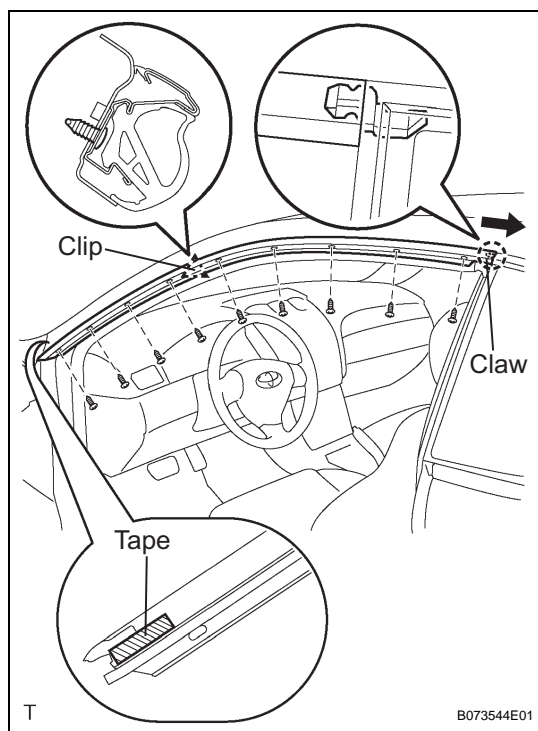

3. INSTALL ROOF DRIP SIDE FINISH MOULDING LH

- Remove the tape from the moulding.
- Clean the contact surface of the body with white gasoline.
- Clean the outer circumference of the moulding with white gasoline.
- Heat the body and moulding.

NOTICE:

Do not heat the body and moulding excessively.

- When replacing the moulding:
Remove the peeling paper from the moulding face.
HINT:

After removing the peeling paper, keep the exposed adhesive away from dirt and other contaminants.

NOTICE:

Do not apply excessive force onto the moulding, but steady pressure with your thumbs.

- Attach the moulding claw in the direction indicated by the arrow mark and then attach the front of the moulding.
- Install the clip.
- Install the 9 screws.

4. INSTALL ROOF SIDE RAIL WEATHERSTRIP LH

- Clean the contact surface of the body with white gasoline.
- Clean the outer circumference of the weatherstrip with white gasoline.
- Heat the body and weatherstrip.

NOTICE:

Do not heat the body and moulding excessively.

- Remove the peeling paper from the weatherstrip face.

HINT:

After removing the peeling paper, keep the exposed adhesive away from dirt and other contaminants.

- Heat the body and weatherstrip.
- Before removing the center pillar peeling paper, install the 4 clips labeled B.
- Remove the peeling paper from the lower end of the tape.
- Remove the peeling paper while pressing the tape on the center pillar section. Install the 2 clips labeled C.
- Insert the front pillar portion of the weatherstrip.
- Install the 2 clips labeled A.

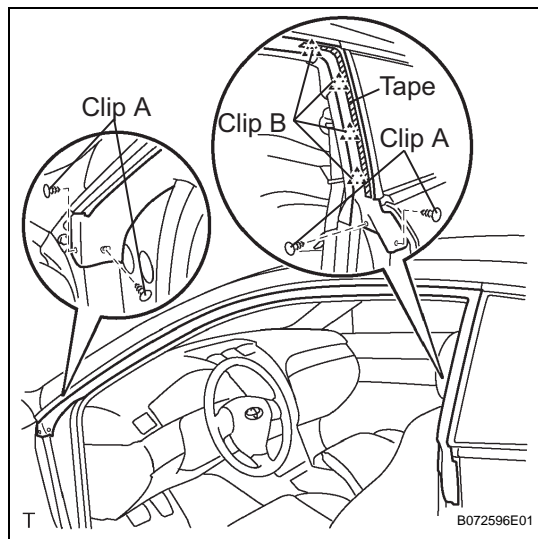

ROOF DRIP SIDE FINISH MOULDING (for Coupe)

REMOVAL

HINT:

- Use the same procedures for the RH side and LH side.
- The procedures listed below are for the LH side.
- When replacing the moulding, heat the body and moulding using a heat light.

Heating temperature

Item	Temperature
Body	40 to 60°C (104 to 140°F)
Moulding	20 to 30°C (68 to 86°F)

ET

NOTICE:

Do not heat the body and moulding excessively.

1. REMOVE ROOF SIDE RAIL WEATHERSTRIP LH

- (a) Heat the weatherstrip.

HINT:

The double-sided tape attaches the weatherstrip to the vehicle body. Heating the weatherstrip melts the adhesive on the double-sided tape, making the weatherstrip easier to remove.

- (b) Remove the 4 clips labeled A.
- (c) Disengage the 4 clips labeled B and remove the weatherstrip.

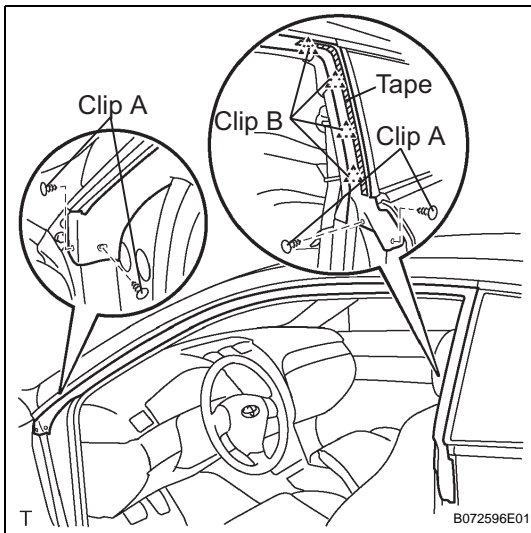

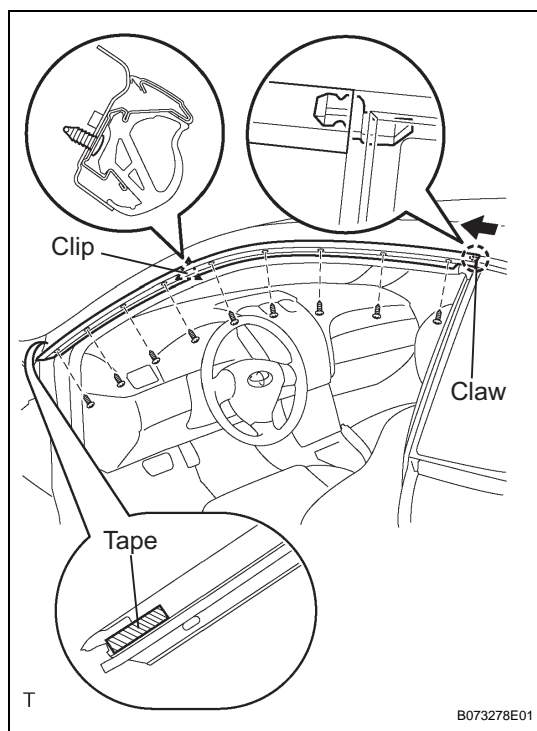

2. REMOVE ROOF DRIP SIDE FINISH MOULDING LH

- Remove the 9 screws.
- Heat the moulding.
- Pull out the front of the moulding and then remove the moulding in the direction indicated by the arrow mark.

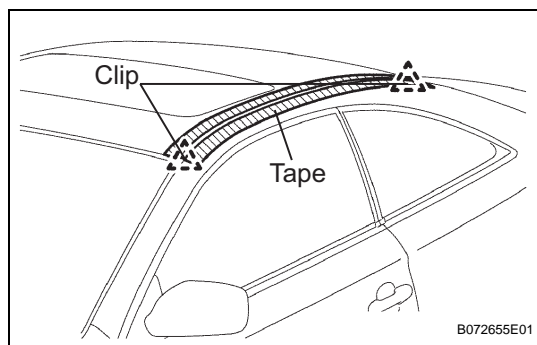

3. REMOVE ROOF DRIP SIDE FINISH MOULDING CENTER LH

- Put protective tape around the edges of the moulding.
- Using a moulding remover, disengage the moulding's front and rear end 2 clips from the vehicle. Remove the moulding.

NOTICE:

- Do not remove the clips from vehicle body.
- If the clips are damaged or removed accidentally, replace them.

ROOF DRIP SIDE FINISH MOULDING (for Convertible)

REMOVAL

HINT:

- Use the same procedures for the RH side and LH side.
- The procedures listed below are for the LH side.
- When replacing the moulding, heat the body and moulding using a heat light.

Heating temperature

Item	Temperature
Body	40 to 60°C (104 to 140°F)
Moulding	20 to 30°C (68 to 86°F)

ET

NOTICE:

Do not heat the body and moulding excessively.

1. REMOVE REMOVABLE ROOF WEATHERSTRIP FRONT

- (a) Remove the 4 clips labeled A.
- (b) Disengage the 2 clips labeled B and remove the weatherstrip.

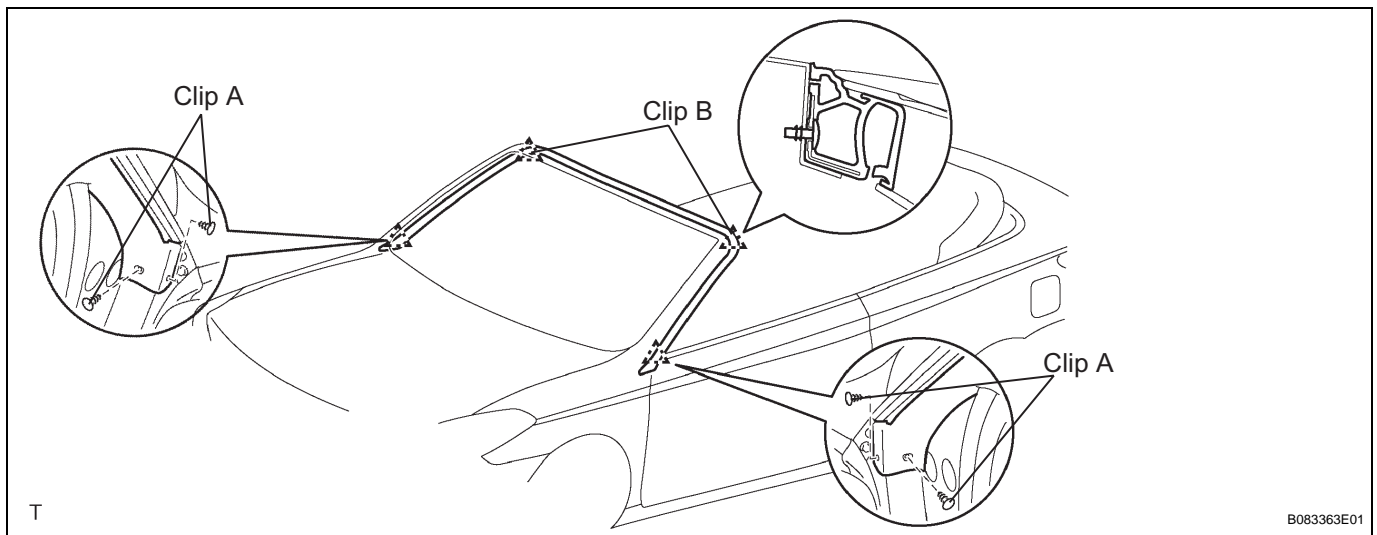

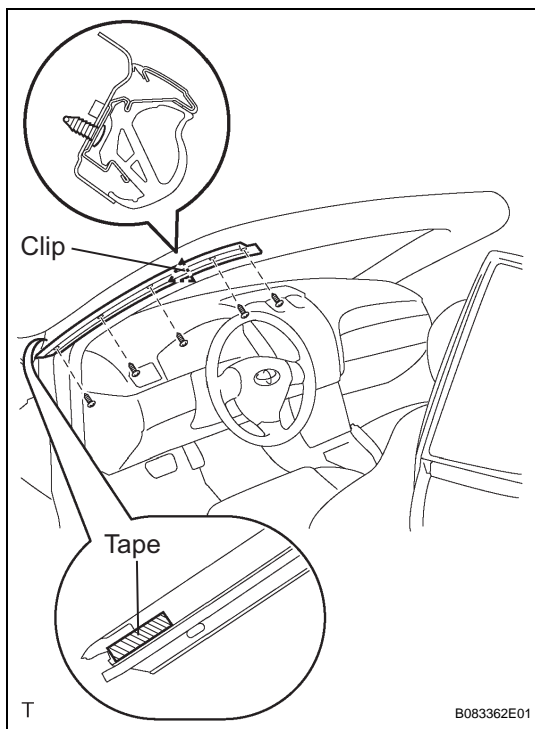

2. REMOVE ROOF DRIP SIDE FINISH MOULDING LH

- (a) Remove the 5 screws.
- (b) Heat the moulding and remove the moulding with the clip.

NOTICE:

Do not heat the body and moulding excessively.

INSTALLATION

1. INSTALL ROOF DRIP SIDE FINISH MOULDING LH

- (a) Remove the tape from the moulding.
- (b) Clean the contact surface of the body with white gasoline.
- (c) Clean the outer circumference of the moulding with white gasoline.
- (d) Heat the body and moulding.

NOTICE:

Do not heat the body and moulding excessively.

- (e) When replacing the moulding:
Remove the peeling paper from the moulding face.

NOTICE:

Do not apply excessive force onto the moulding, but steady pressure with your thumbs.

HINT:

After removing the peeling paper, keep the exposed adhesive away from dirt and other contaminants.

- (f) Install the moulding with the clip.
- (g) Install the 5 screws.

2. INSTALL REMOVABLE ROOF WEATHERSTRIP FRONT

- (a) Install the 2 clips labeled B with the weatherstrip.

(b) Install the 4 clips labeled A.

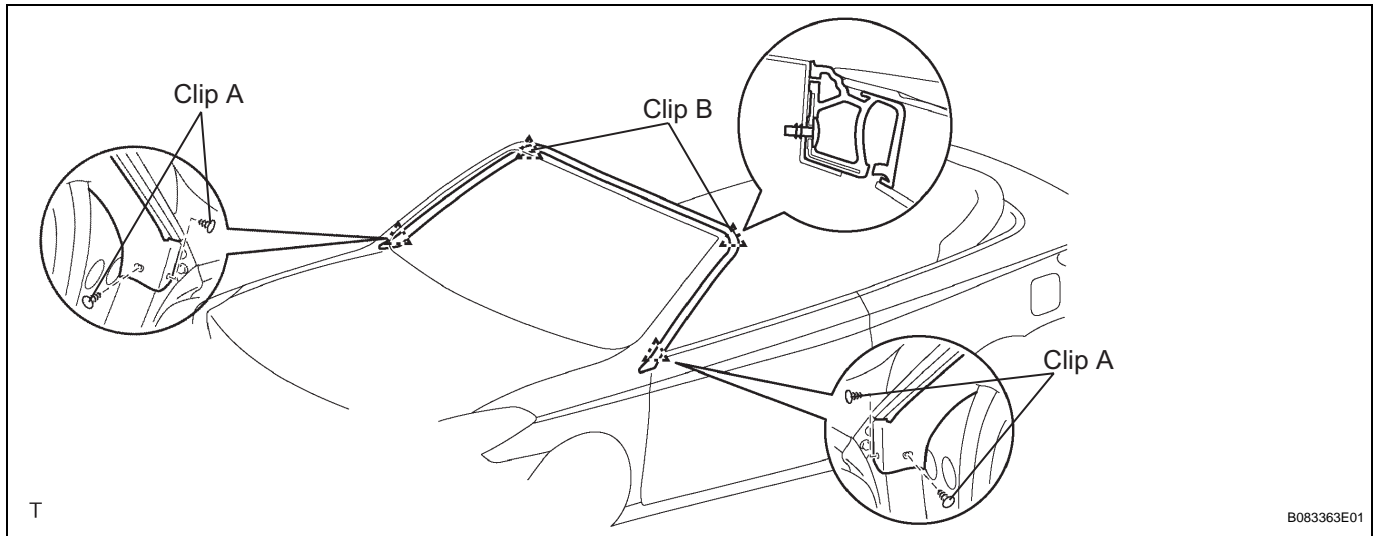

INSTALLATION

1. INSTALL ROCKER PANEL MOULDING LH

NOTICE:

If the clips are damaged, replace them.

(a) Install the moulding with the 4 clips.

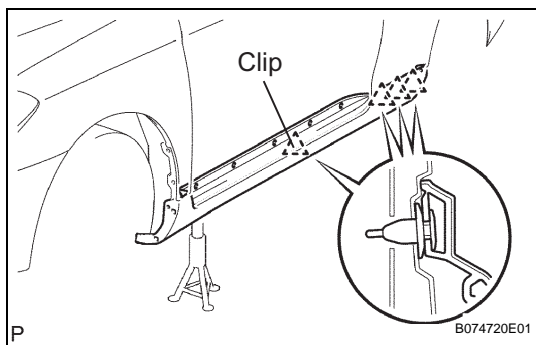

(b) Install the 10 screws.

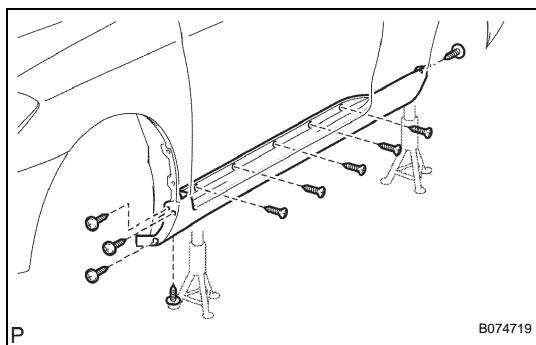

(c) Install 6 new clips.

NOTICE:

Always use new clips at the time of installation.

(d) Install the front wheel and rear wheel.

(e) Set jacks under the vehicle and remove the stands.

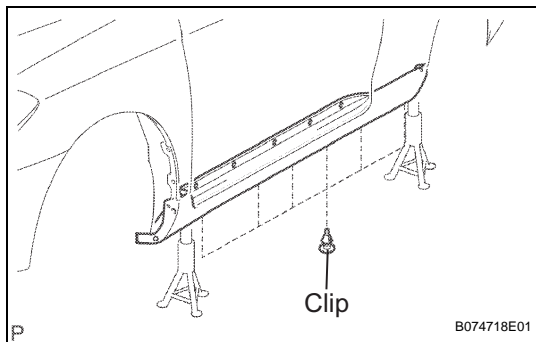

ROCKER PANEL MOULDING

COMPONENTS

ET

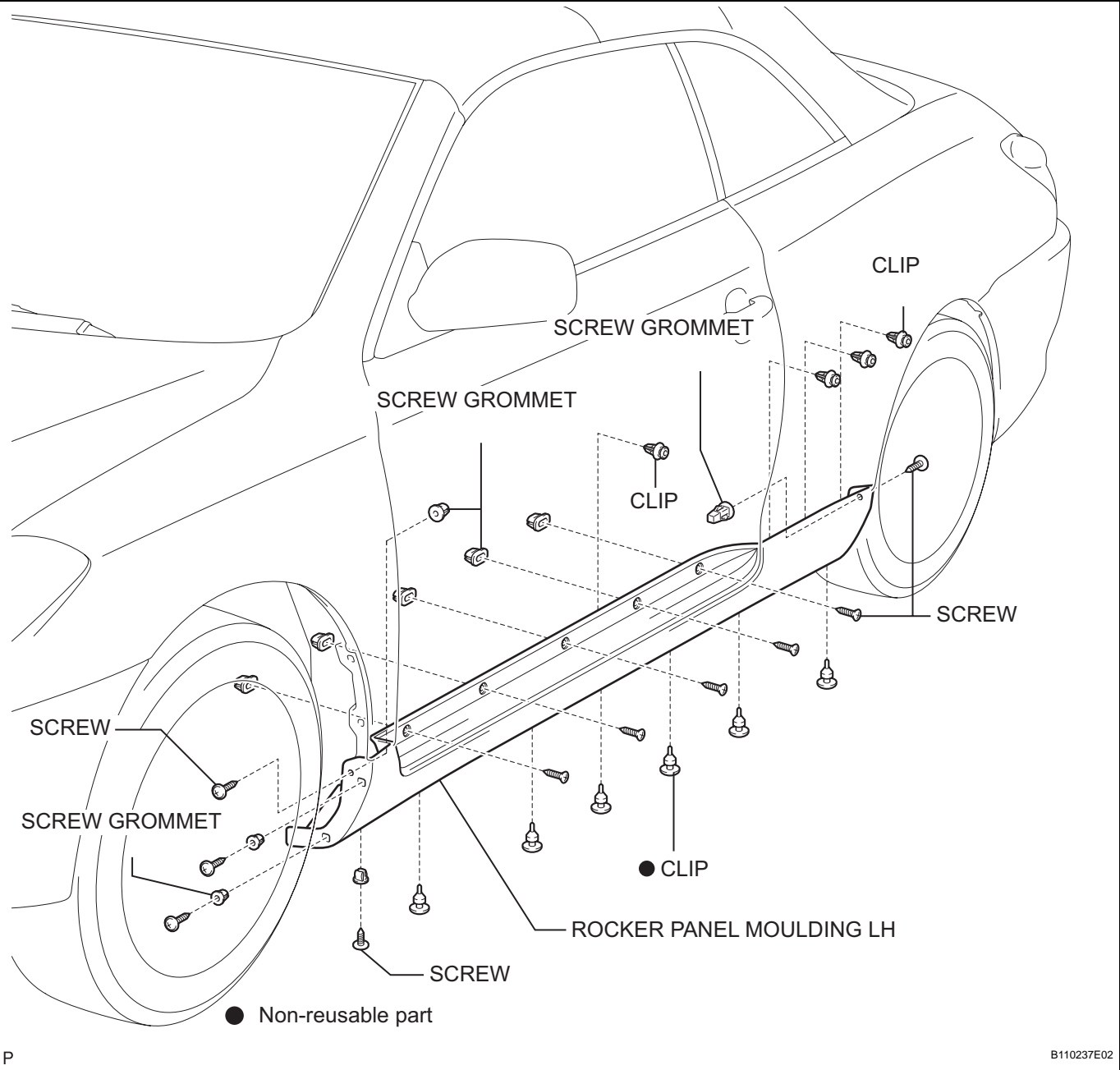

REMOVAL

HINT:

- Use the same procedures for the RH side and LH side.
- The procedures listed below are for the LH side.

1. REMOVE ROCKER PANEL MOULDING LH

- (a) Jack up the vehicle and mount the vehicle onto stands.
- (b) Remove the front wheel and rear wheel.
- (c) Remove the 6 clips.

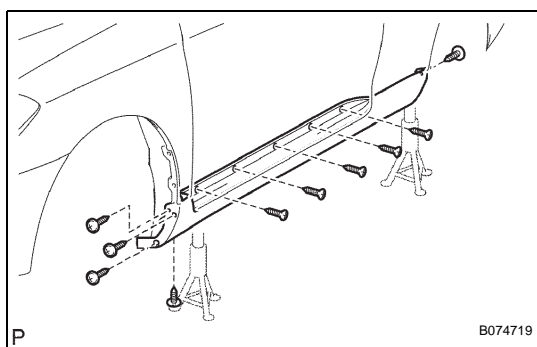
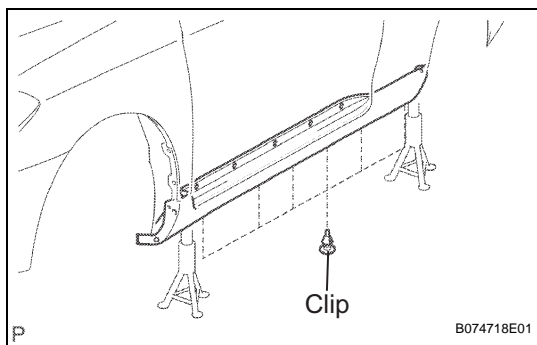

- (d) Remove the 10 screws.

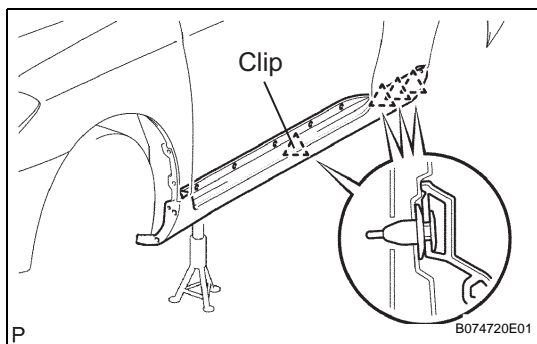

- (e) Disengage the 4 clips and remove the moulding.